



**PUBLIC PATH DIVERSION AND
DEFINITIVE MAP AND STATEMENT MODIFICATION ORDER**

**HIGHWAYS ACT 1980
WILDLIFE AND COUNTRYSIDE ACT 1981**

SHROPSHIRE COUNCIL

**THE SHROPSHIRE COUNCIL (FOOTPATH 4 (PART), PARISH OF BORASTON)
PUBLIC PATH DIVERSION ORDER 2025**

This Order is made by the Shropshire Council ("the Council") under section 119 of the Highways Act 1980 ("the 1980 Act") because it appears to the Council that in the interests of the landowners of the land crossed by the footpath described in paragraph 1 of this order it is expedient that the line of the way should be diverted.

This Order is also made under section 53A (2) of the Wildlife Countryside Act 1981 ("the 1981 Act") because it appears to the authority that the Shropshire definitive map and statement require modification in consequence of the occurrence of an event specified in section 53(3)(a)(i) of the 1981 Act, namely, the diversion (as authorised by this Order) of a highway shown or required to be shown in the map and statement.

BY THIS ORDER:

1. The public right of way over the land situated in the Parish of Boraston and shown by a bold continuous line on the map contained in this Order and described in Part 1 of the Schedule to this Order shall be stopped up on the date of confirmation of this Order and thereupon the Shropshire definitive map shall be modified by deleting from it that public right of way.

2. Notwithstanding paragraph 1 of this Order statutory undertakers shall have the following rights over the land referred to in paragraph 1 above, namely:

Where immediately before the date on which the footpath is diverted there is apparatus under, in, on, over, along or across it belonging to statutory undertakers for the purpose of carrying on their undertaking, the undertakers shall continue to have the same right in respect of the apparatus as they then had.

3. There shall on the date of confirmation of this Order be a public footpath over the land situated in the Parish of Boraston described in Part 2 of the Schedule and shown by a bold broken line on the map contained in this Order and thereupon the Shropshire definitive map shall be modified by adding that path to it.

3A. The Shropshire definitive statement shall be modified as described in Part 4 of the Schedule to this order.

4. The diversion of the footpath shall only have effect on the date on which Shropshire Council certifies that any works required to bring the footpath into a fit condition have been carried out.

5. The rights conferred on the public under this Order shall be subject to the limitations and conditions set out in Part 3 of the Schedule.

SCHEDULE

PART I

Description of site of existing path or way

The full width of Boraston Footpath 4 (part) commencing from grid reference SO 6136 7234, Point A on the Order Map, running in a general south-southeast, then southerly, then south-southwest direction to grid reference SO 6146 7157, continuing in an easterly direction to meet a footbridge across the Corn Brook at grid reference: SO 6153 7157, Point C on the Order Map. A total distance of approximately 930 metres.

PART 2

Description of site of new path or way

A footpath will be created commencing from the County Road at grid reference SO 6136 7234, Point A on the Order Map, and then running in a general south-south-east direction following an open field boundary, passing around the western edge of a pond, continuing in a general south-east, then southerly direction along the field edge to grid reference SO 6148 7194, continuing in a general east then south-east direction along the field edge to grid reference SO 6175 7181, continuing in a general northeast direction to where it meets the County Road at grid reference SO 6178 7184, Point B on the Order Map. A total distance of approximately 870 metres with a width of 2 metres throughout.

PART 3

Limitations and conditions

Stile located at grid reference: SO 6136 7234

Gate located at grid reference: SO 6178 7184

PART 4

Modification of Definitive Statement

A footpath will be created commencing from the County Road at grid reference SO 6136 7234, Point A on the Order Map, and then running in a general south-south-east direction following an open field boundary, passing around the western edge of a pond, continuing in a general south-east, then southerly direction along the field edge to grid reference SO 6148 7194, continuing in a general east then south-east direction along the field edge to grid reference SO 6175 7181, continuing in a general northeast direction to where it meets the County Road at grid reference SO 6178 7184, Point B on the Order Map. A total distance of approximately 870 metres with a width of 2 metres throughout.

There is no Shropshire definitive statement for the remainder of this Right of Way.

Variation of Particulars of Path or Way

None

Executed as a deed by affixing the
Common Seal of Shropshire Council

In the presence of:

Tim Collard



513511

Tim Collard
Assistant Director, Legal and Governance
(Monitoring Officer)

The Shropshire Council
in exercise of the powers
conferred upon them in that
behalf hereby confirm the
foregoing order

Executed as a deed by affixing the Common
Seal of Shropshire Council

In the presence of:

KBB

Legal Team Leader
Regulatory and Environment



515069

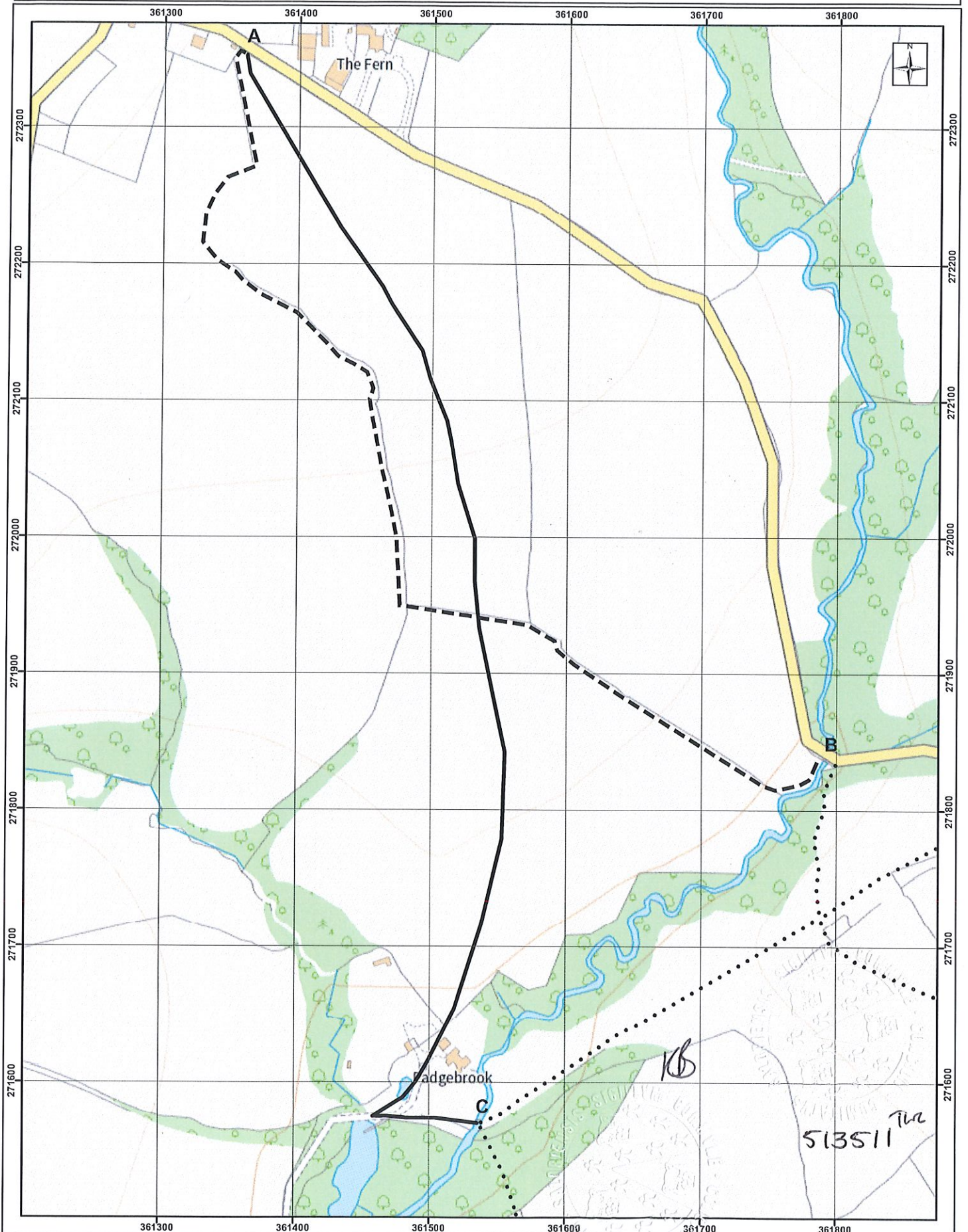

DATED 13th February 2025

PUBLIC PATH DIVERSION AND
DEFINITIVE MAP AND STATEMENT
MODIFICATION ORDER
HIGHWAYS ACT 1980 (SECTION 119)
WILDLIFE AND COUNTRYSIDE ACT 1981

THE SHROPSHIRE COUNCIL
(FOOTPATH 4 (PART), PARISH OF
BORASTON) PUBLIC PATH DIVERSION
ORDER 2025

SHROPSHIRE OUTDOOR PARTNERSHIPS SERVICE
HOMES AND COMMUNITIES

THE SHIREHALL
ABBAY FOREGATE
SHREWSBURY

This information is supplied in connection with an order made by Shropshire Council under the Highways Act 1980 and is not to be used for any other purpose. Shropshire Council asserts its right to the copyright of this order. It may not be reproduced or transmitted in any other form or by any means or stored in any retrieval system of any nature without prior written permission except for the purposes of this consultation.