



SHROPSHIRE COUNCIL

WILDLIFE AND COUNTRYSIDE ACT 1981

DEFINITIVE MAP AND STATEMENT OF RIGHTS OF WAY FOR SHROPSHIRE

THE SHROPSHIRE COUNCIL (BRIDLEWAY 28 & BRIDLEWAY 29 (PART) DELETION AND ADDITION, PARISHES OF CHURCH PULVERBATH & LONGDEN) MODIFICATION ORDER 2023

This Order is made by The Shropshire Council ("the Council") under section 53(2)(b) of the Wildlife and Countryside Act 1981 ("the Act") because it appears to the Council that the Shropshire Definitive Map and Statement require modification because in accordance with the provisions of Section 53(3)(c)(i) and (iii) the Council has discovered evidence which (when considered with all other relevant evidence available to them) shows -

- (i) that a right of way which is not shown on the map and statement subsists or is reasonably alleged to subsist over land in the area to which the map relates, being a right of way such that the land over which the right subsists is a public path, a restricted byway or, subject to section 54A, a byway open to all traffic and
- (ii) that there is no public right of way over the land shown in the map and statement as a highway of any description, or any other particulars contained in the map and statement require modification.

The Council hereby order that:-

1. For the purpose of this Order the relevant date is 7th June 2023.
2. The Shropshire Definitive Map and Statement shall be modified as described in Part I and Part II of the Schedule and shown on the map attached to the Order.
3. This Order shall take effect on the date it is confirmed and may be cited as The Shropshire Council (Bridleway 28 & Bridleway 29 (part) Deletion and Addition, Parishes of Church Pulverbatch & Longden) Modification Order 2023.

SCHEDULE

PART I

Modification of Definitive Map

Description of path or way to be deleted

Deleting the whole width of Bridleway 28 from Point A on the Order Map grid reference SJ 4106 0344 running in a general NNE direction within Browns Coppice in the parish of Church Pulverbatch to the parish boundary where it meets Bridleway 29 in the parish of Longden. Also deleting the full width of that part of Bridleway 29 running in a general NW direction then NNE direction across fields to Old Lodge, crossing through the grounds where it then turns to run in a general Easterly direction into Oaks Wood to a bridge and then a gate at Point B on the Order Map grid reference SJ 4140 0396. A total approximate distance of 934 metres.

Description of path or way to be added

Bridleway to be added from Point C on the Order Map grid reference SJ 4104 0346 leaving the County Road and running in a NNE to direction to some gates at grid reference SJ 4104 0347 before continuing along the access track in the parish of Church Pulverbatch. Then continuing in a generally northerly direction within the parish of Longden where it turns to run in a general NNW direction then northerly direction along the access track until it turns to run in a general easterly direction through Oaks Wood, to a bridge and then gate at Point B on the Order Map grid reference SJ 4140 0396. Where the Bridleway follows the access track the width varies between 3-5 metres, where the Bridleway enters Oaks Wood from the access track the route varies between 1-3 metres. An approximate distance of 826 metres.

PART II

Modification of Definitive Statement

Bridleway to be added from Point C on the Order Map grid reference SJ 4104 0346 leaving the County Road and running in a NNE to direction to some gates at grid reference SJ 4104 0347 before continuing along the access track in the parish of Church Pulverbatch. Then continuing in a generally northerly direction within the parish of Longden where it turns to run in a general NNW direction then northerly direction along the access track until it turns to run in a general easterly direction through Oaks Wood, to a bridge and then gate at Point B on the Order Map grid reference SJ 4140 0396. Where the Bridleway follows the access track the width varies between 3-5 metres, where the Bridleway enters Oaks Wood from the access track the route varies between 1-3 metres. An approximate distance of 826 metres.

Limitations

Gates at Grid Reference SJ 4104 0347 to BS 5709
Bridge and Gate at Grid Reference SJ 4140 0396 Gate to BS 5709

510749

Executed as a deed by affixing the
Common Seal of Shropshire Council
on 23rd June 2023
in the presence of:-

Tim Collard

Tim Collard
Assistant Director, Legal and Governance
(Monitoring Officer)

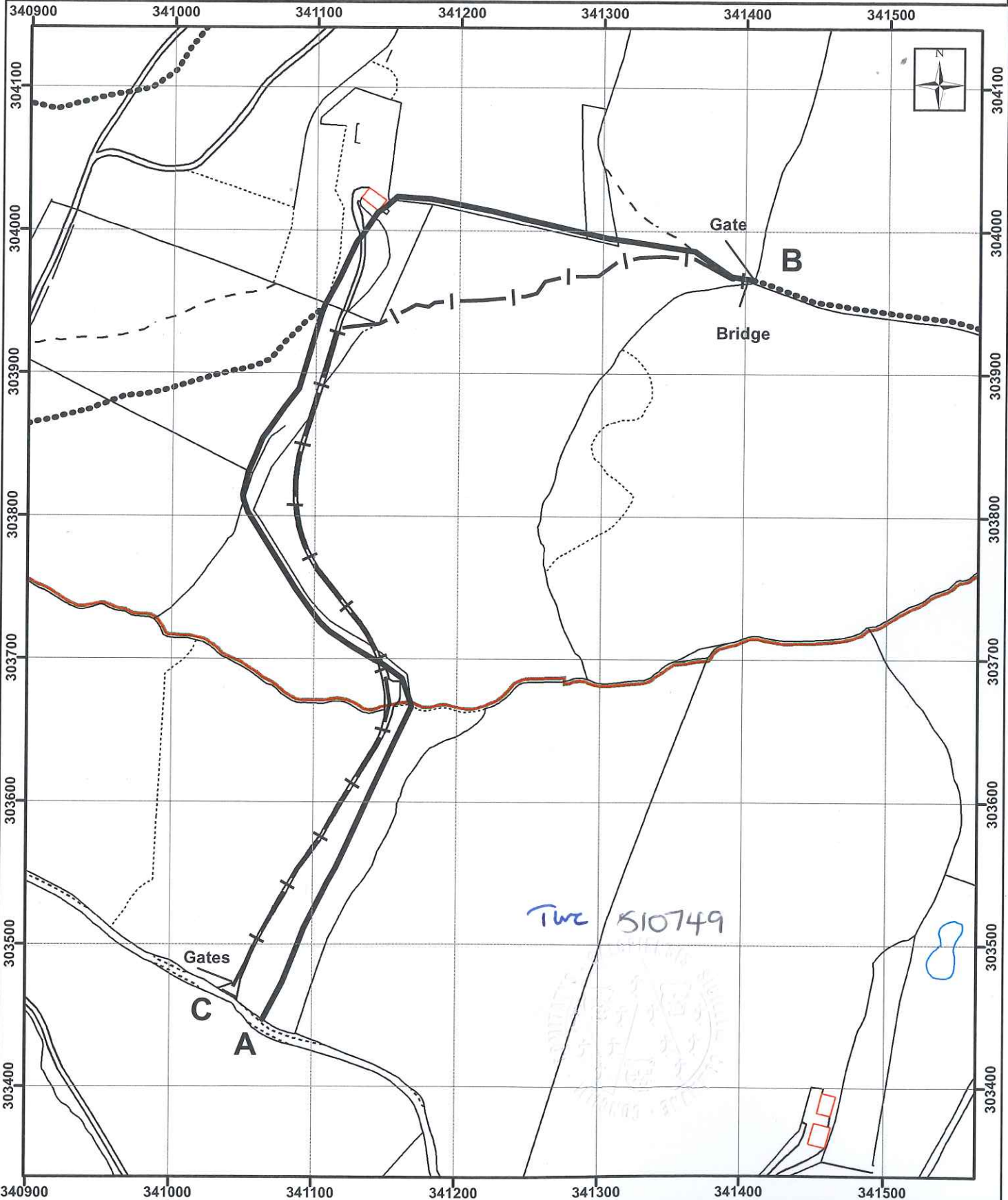

Key	
Route to be added	— — — — —
Route to be deleted	—————
Existing to remain

DATED 22nd June 2023

SHROPSHIRE COUNCIL

WILDLIFE AND COUNTRYSIDE ACT 1981

DEFINITIVE MAP AND STATEMENT OF
RIGHTS OF WAY FOR SHROPSHIRE

THE SHROPSHIRE COUNCIL
(BRIDLEWAY 28 & BRIDLEWAY 29 (PART) DELETION
AND ADDITION, PARISHES OF CHURCH
PULVERBATCH & LONGDEN MODIFICATION ORDER
2023

SHROPSHIRE OUTDOOR PARTNERSHIPS SERVICE
HOMES AND COMMUNITIES
THE SHIREHALL
ABBAY FOREGATE
SHREWSBURY

This information is supplied in connection with an Order made by Shropshire Council under the Wildlife and Countryside Act 1981 and is not to be used for any other purpose. Shropshire Council asserts its right to the copyright of this Order. It may not be reproduced or transmitted in any form or by any means or stored in any retrieval system of any nature except with prior written permission except for the purposes of this consultation.