

Legend

- - - Footpath
- - - Permissive Footpath
- - - Bridleway
- - - Permissive Bridleway
- - - Restricted Byway
- - - Byway Open to all Traffic
- ▭ parish

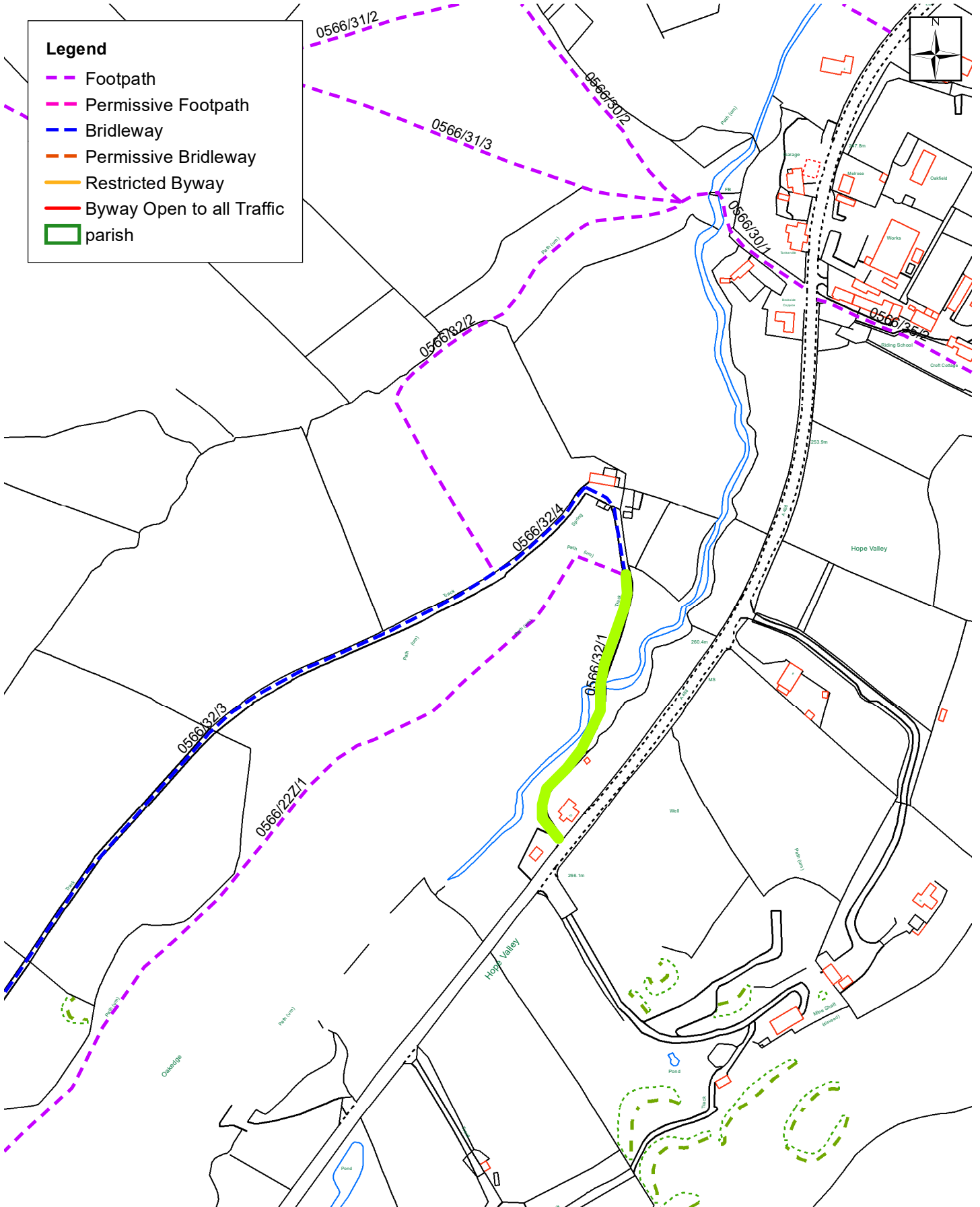

This is not the legal definitive map. It is a working copy only. For information purposes only.



Route to be Temporarily Closed:

Scale: 1:3,000

(c) Crown copyright (2023) 100049049.

The Shirehall, Abbey Foregate
Shrewsbury, Shropshire, SY2 6ND

map produced by on /08 K:user groups.countryside/provate/projects/ .mxd