

**TYPICAL CROSS-SECTION**  
Scale 1:20

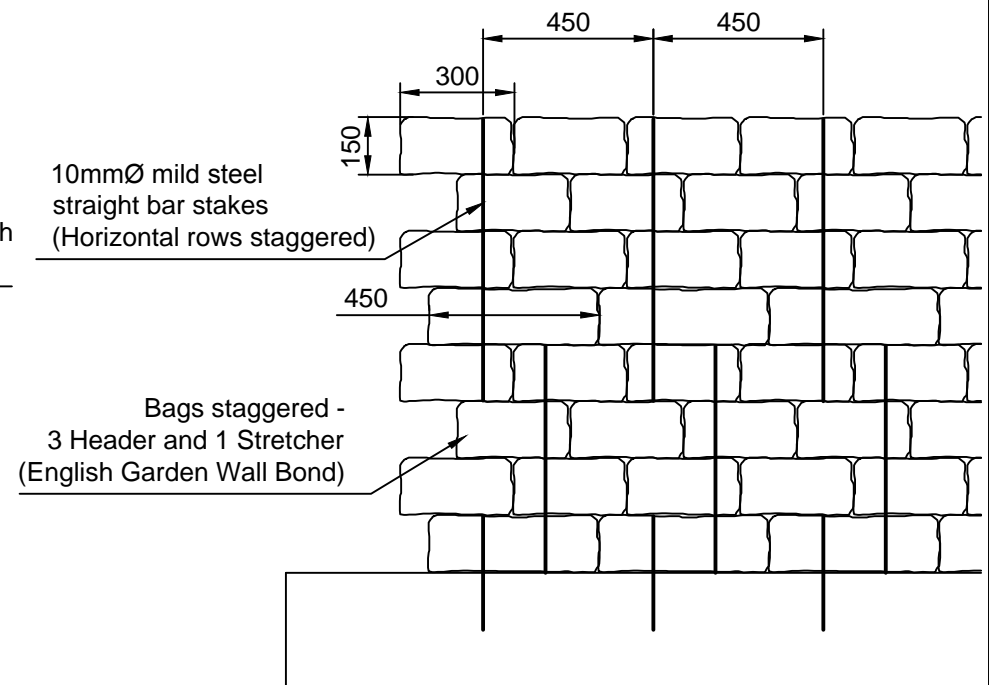

**TYPICAL ELEVATION**  
Scale 1:20

**Notes**

1. ST4 concrete to be used to fill hessian bags. Concrete to have a slump of 25 mm.
2. The bags shall be hessian sand bags complying with BS 1214. The size of the bags shall be such that when fully filled, the dimensions shall be 450 mm x 300 mm x 150 mm.
3. The bags shall be placed in position and shaped to the profile shown on the Drawings by striking with a flat timber board until all faces are flat and all edges square.
4. The finished exposed faces of the bagwork shall not be punctured or torn and no tucked ends shall be visible.
5. Every concrete bag to be spiked to the one below using 10mm mild steel bars. Bars at end of each days work to project a minimum 150mm to allow tying in of following days work.
6. Where the concrete bags have a concrete backing, alternate rows of bags shall be spiked to the backing concrete with 10 mmØ mild steel dowel bars at 45 degrees to the horizontal with one dowel per bag in the row.
7. The bagwork shall be thoroughly soaked with water upon completion of the construction to saturate the hessian bags



Drawing Title:

**Standard Detail  
Concrete Bagwork**

Version:	Amendment	Date
Checked By: TRE	Drawing Number: SD-500-21	Version: -
Date Issued: Oct 16		