



**PUBLIC PATH DIVERSION AND
DEFINITIVE MAP AND STATEMENT MODIFICATION ORDER**

**HIGHWAYS ACT 1980
WILDLIFE AND COUNTRYSIDE ACT 1981**

SHROPSHIRE COUNCIL

**THE SHROPSHIRE COUNCIL (FOOTPATH 38 (PART), PARISH OF EATON-
UNDER-HEYWOOD)
PUBLIC PATH DIVERSION ORDER 2025**

This Order is made by the Shropshire Council ("the Council") under section 119 of the Highways Act 1980 ("the 1980 Act") because it appears to the Council that in the interests of the landowners of the land crossed by the footpath described in paragraph 1 of this order it is expedient that the line of the way should be diverted.

This Order is also made under section 53A (2) of the Wildlife Countryside Act 1981 ("the 1981 Act") because it appears to the authority that the Shropshire definitive map and statement require modification in consequence of the occurrence of an event specified in section 53(3)(a)(i) of the 1981 Act, namely, the diversion (as authorised by this Order) of a highway shown or required to be shown in the map and statement.

BY THIS ORDER:

1. The public right of way over the land situated at Wolverton Manor Farm in the Parish of Eaton-under-Heywood and shown by a bold continuous line on the map contained in this Order and described in Part 1 of the Schedule to this Order shall be stopped up on the date of confirmation of this order and thereupon the Shropshire definitive map shall be modified by deleting from it that public right of way.

2. Notwithstanding paragraph 1 of this Order statutory undertakers shall have the following rights over the land referred to in paragraph 1 above, namely: Where immediately before the date on which the footpath is diverted there is apparatus under, in, on, over, along or across it belonging to statutory undertakers for the purpose of carrying on their undertaking, the undertakers shall continue to have the same right in respect of the apparatus as they then had.

3. There shall on the date of confirmation of this Order be a public footpath over the land situated at Wolverton Manor Farm in the Parish of Eaton-under-Heywood described in Part 2 of the Schedule and shown by a bold broken line on the map contained in this Order and thereupon the Shropshire definitive map shall be modified by adding that path to it.

3A. The Shropshire definitive statement shall be modified as described in Part 4 of the Schedule to this order.

4. The diversion of the footpath shall only have effect on the date on which Shropshire Council certifies that any works required to bring the footpath into a fit condition have been carried out.

5. The rights conferred on the public under this Order shall be subject to the limitations and conditions set out in Part 3 of the Schedule.

SCHEDULE

PART I

Description of site of existing path or way

The full width of Eaton-under-Heywood footpath 38 (part) commencing from the remainder of footpath 38 that is to remain at grid reference SO 4719 8783, Point A on the Order Map, and then running in a general north-northwest direction to grid reference SO 4713 8793, continuing in a general north-west direction to where it passes across the County Road at grid reference SO 4710 8798, continuing in a general north-northwest direction to grid reference SO 4687 8837, continuing in a general north direction to grid reference SO 4680 8872, continuing in a general north-west direction to where it meets the continuation of footpath 38 that is to remain at grid reference SO 4666 8882, Point B on the Order Map. A total distance of approximately 1180 metres.

PART 2

Description of site of new path or way

A footpath will be created commencing from the remainder of footpath 38 at grid reference SO 4719 8783, Point A on the Order Map, and then running in a general north-northeast direction to where it meets the County Road at grid reference SO 4725 8804, continuing from the opposite side of the County Road at grid reference SO 4725 8806 in a general north-northeast direction to grid reference SO 4726 8811, continuing in a general north-west direction to grid reference SO 4689 8839, continuing in a general north-northwest direction to re-join the continuation of footpath 38 at grid reference SO 4666 8882, Point B on the Order Map. A total distance of approximately 1230 metres with a width of 2 metres throughout.

PART 3

Limitations and conditions

Gates are located at grid references: SO 4719 8783, SO 4725 8804, SO 4725 8806 and SO 4689 8839

PART 4

Modification of Definitive Statement

A footpath will be created commencing from the remainder of footpath 38 at grid reference SO 4719 8783, Point A on the Order Map, and then running in a general north-northeast direction to where it meets the County Road at grid reference SO 4725 8804, continuing from the opposite side of the County Road at grid reference SO 4725 8806 in a general north-northeast direction to grid reference SO 4726 8811, continuing in a general north-west direction to grid reference SO 4689 8839, continuing in a general north-northwest direction to re-join the continuation of footpath 38 at grid reference SO 4666 8882, Point B on the Order Map. A total distance of approximately 1230 metres with a width of 2 metres throughout

There is a Shropshire definitive statement entry for part of this Right of Way, however, the part described will not be affected by this Order. The part described does not connect to the part of this Right of Way that is subject to this Order.

Variation of Particulars of Path or Way

None

Executed as a deed by affixing the
Common Seal of Shropshire Council

In the presence of:

513763



Miranda Garrard
Head of Legal and Democratic Services

The Shropshire Council
in exercise of the powers
conferred upon them in that
behalf hereby confirm the
foregoing order

Executed as a deed by affixing the Common
Seal of Shropshire Council



515693

In the presence of:

Rhian Cains
Interim Head of Legal Services

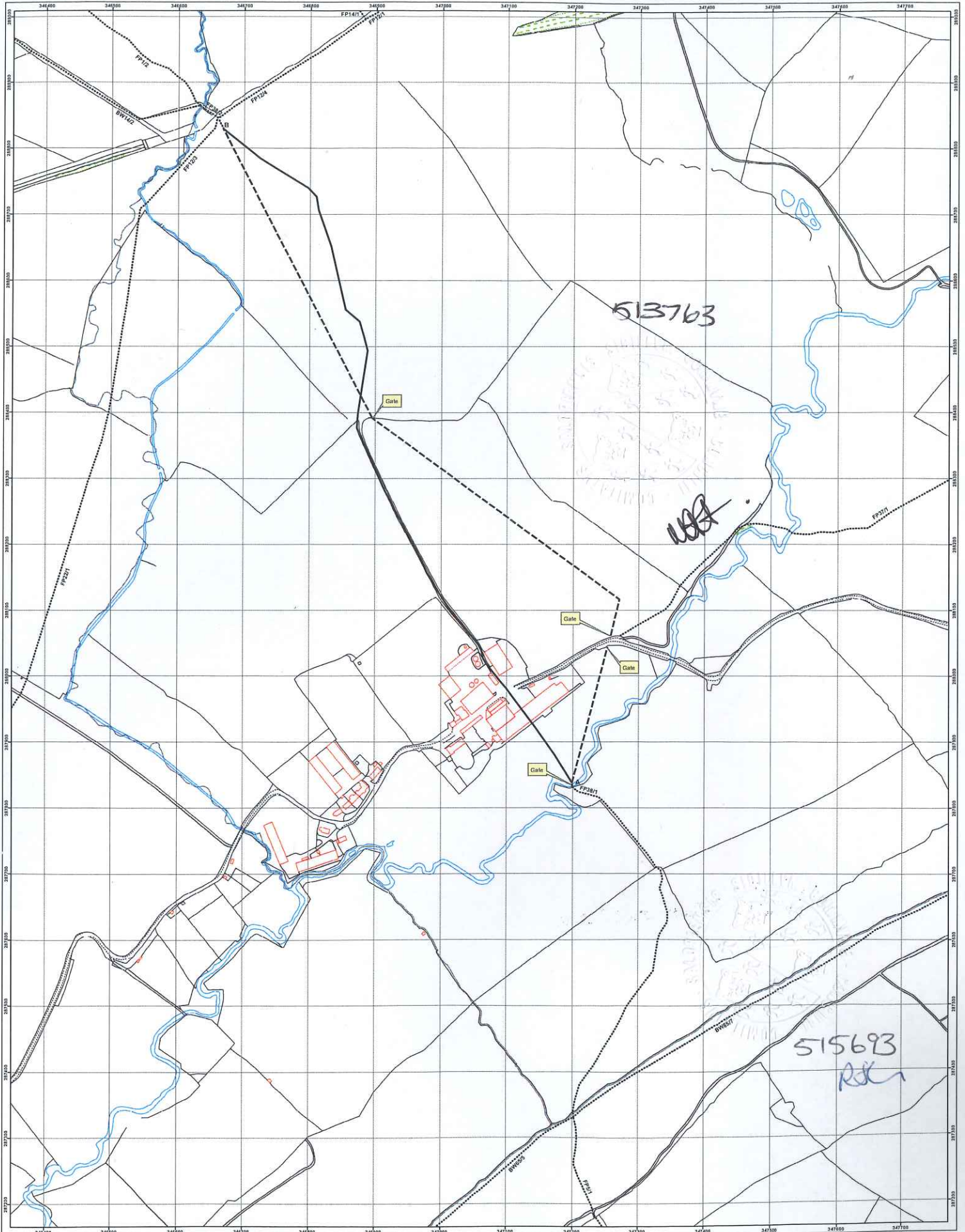

Key
 Route to be created ———
 Route to be extinguished - - - - -
 Existing to remain
 Shropshire Council
 The Shropshire Planning Department
 Shrewsbury, Shropshire, SY2 8AD

© Crown copyright (2025) Ordnance Survey. All rights reserved.
 You are not permitted to copy this licence. It is the property of the Crown.
 No part of this data may be reproduced in any form.

Scale: 1:2,500

DATED 20th March 2025

PUBLIC PATH DIVERSION AND
DEFINITIVE MAP AND STATEMENT
MODIFICATION ORDER
HIGHWAYS ACT 1980 (SECTION 119)
WILDLIFE AND COUNTRYSIDE ACT 1981

THE SHROPSHIRE COUNCIL
(FOOTPATH 38 (PART), PARISH OF
EATON-UNDER-HEYWOOD) PUBLIC
PATH DIVERSION ORDER 2025

SHROPSHIRE OUTDOOR PARTNERSHIPS SERVICE
HOMES AND COMMUNITIES

THE SHIREHALL
ABBAY FOREGATE
SHREWSBURY

This information is supplied in connection with an order made by Shropshire Council under the Highways Act 1980 and is not to be used for any other purpose. Shropshire Council asserts its right to the copyright of this order. It may not be reproduced or transmitted in any other form or by any means or stored in any retrieval system of any nature without prior written permission except for the purposes of this consultation.