

PART A: Information relating to the applicant and land to which the application relates

(all applicants must complete this Part)

1. Name of appropriate authority to which the application is addressed:

SHROPSHIRE COUNCIL.

2. Name and full address (including postcode) of applicant:

NA. FORSTER,
"MOSS COTTAGE FARM",
HASSALL ROAD,
WINTERLEY,
SAMBACH,
CHESHIRE, CW11 4RU.

3. Status of applicant *(tick relevant box or boxes)*:

I am PART

(a) the owner of the land(s) described in paragraph 4.

(b) making this application and the statements/declarations it contains on behalf

MR. J. W. FORSTER, MR. W. R. FORSTER ARE JOINT
of ~~MRS. B. FORSTER~~ who is the owner of the land(s) described in paragraph 4

[insert name of owner]
and in my capacity as PART OWNER.
[insert details e.g. trustee/landowner's agent]

4. Insert description of the land(s) to which the application relates (including full address and postcode):

APPROX. 18 ACRES OF LAND KNOWN AS
THE MEADOWS,
ST. MARTINS ROAD,
GOBOWEN,
NR. OSWESTRY,
SHROPSHIRE.

5. Ordnance Survey six-figure grid reference(s) of a point within the area of land(s) to which the application relates (if known):

ST. 303342.

6. This deposit comprises the following statement(s) and/or declarations
(delete Parts B, C or D where not applicable):

PART B: Statement under section 31(6) of the Highways Act 1980

[I am/ ----- is] the owner of the land described in paragraph 4 of
[insert name of owner]

Part A of this form and shown ----- on the map accompanying this statement.
[insert colouring]

(delete wording in square brackets as appropriate and/or insert information as required)

[Ways shown ----- on the accompanying map are byways open to all traffic.]
[insert colouring]

[Ways shown ----- on the accompanying map are restricted byways.]
[insert colouring]

[Ways shown ----- on the accompanying map are public bridleways.]
[insert colouring]

[Ways shown ----- on the accompanying map are public footpaths.]
[insert colouring]

No [other] ways over the land shown ----- on the accompanying map have been
[insert colouring]
dedicated as highways.

(delete wording in square brackets as appropriate and/or insert information as required)

PART C: Declaration under section 31(6) of the Highways Act 1980

1. [I am ~~MR. N.A. FORSTER, MR. J.W. FORSTER, MR. W.R. FORSTER~~
~~AND MRS. B. FORSTER~~ is] the owner of the land described in paragraph 4 of
[insert name of owner]

Part A of this form and shown IN RED on the map [accompanying this
[insert colouring]

declaration/lodged with Shropshire Council on 1ST. MAR. 2015.
[insert day, month, year].

(delete wording in square brackets as appropriate and/or insert information as required)

2. On the 21ST. day of MARCH [I/my 2005] predecessor
[insert day] [insert month, year] [insert name of owner's]

in title NA. FORSTER deposited with Shropshire Council, being the
[insert name]

appropriate council, a statement accompanied by a map showing

MR. N.A. FORSTER, MR. J.W. FORSTER, MR. W.R. FORSTER
OUR [my] MRS. B. FORSTER property RED which stated that:
[insert name of owner's] [insert colour]

[the ways shown ----- on that map [and on the map accompanying this
[insert colouring]

declaration] had been dedicated as byways open to all traffic]

[the ways shown ----- on that map [and on the map accompanying this
[insert colouring]

declaration] had been dedicated as restricted byways]

[the ways shown ----- on that map [and on the map accompanying this
[insert colouring]

declaration] had been dedicated as bridleways]

[the ways shown PURPLE on that map [and on the map accompanying this
[insert colouring]

declaration] had been dedicated as footpaths].

No [other] ways had been dedicated as highways over OUR MR. N.A. FORSTER, MR. J.W. Fo
[insert name of owner's] ASTER
MR. W.R. FORSTER
& MRS. B. FORSTER.
property].

[3. On the ----- day of ----- [I/my -----] predecessor
[insert day] [insert month, year] [insert name of owner's]

in title] ----- deposited with Shropshire Council, being the
[insert name]

appropriate council, deposited with Shropshire Council, being the appropriate council, a

declaration dated -----, stating that no additional ways [other than
[insert day, month, year]
those marked in the appropriate colour on the map accompanying that declaration] had been
dedicated as [byways open to all traffic] [restricted byways] [brideways] [footpaths] since the
deposit of the statement referred to in paragraph 2 above.]

(delete if not applicable and delete wording in square brackets as appropriate and/or insert information as required)

4. No additional ways have been dedicated over the land RED. on the map
[insert colouring]

[accompanying this declaration/referenced in paragraph 1 above] since the statement
dated 16TH. MAR. 2005 referred to in paragraph 2 above [since the date of
[insert day, month, year]

the declaration referred to in paragraph 3 above] [other than those [byways open to all
traffic] [restricted byways] [brideways] [footpaths] marked in the appropriate colour on the
map accompanying this declaration] and at the present time W. A. FORSTER, J. W. FORSTER
AND
MRS. B. FORSTER
[insert name of owner]

[have/~~has~~] no intention of dedicating any more public rights of way over ^{OUR} [my/the]
property.

(delete wording in square brackets as appropriate and/or insert information as required)

PART D: Statement under section 15A (1) of the Commons Act 2006

N.A. FORSTER, J.W. FORSTER
W.R. FORSTER

^{WE}
~~HE~~ AND MRS. B. FORSTER is the owner^S of the land described in paragraph 4 of
[insert name of owner]

Part A of this form and shown REN on the map [accompanying this
[insert colouring]

statement/deposited with Shropshire Council on 1st. MARCH. 2015.
[insert day, month, year].

[I/ MR. N.A. FORSTER] [wish/wishes] to bring to an end any period during which
[insert name of owner]

persons may have indulged as of right in lawful sports and pastimes on the whole or any part
of the land shown REN on the [accompanying map/map referenced above].
[insert colouring]

(delete wording in square brackets as appropriate and/or insert information as required)

PART E: Additional information relevant to the application

(insert any additional information relevant to the application in the space below)

PART F: Statement of Truth
(all applicants must complete this Part)

WARNING: If you dishonestly enter information or make a statement that you know is, or might be, untrue or misleading, and intend by doing so to make a gain for yourself or another person, or to cause loss or the risk of loss to another person, you may commit the offence of fraud under section 1 of the Fraud Act 2006, the maximum penalty for which is 10 years' imprisonment or unlimited fine, or both.

I BELIEVE THAT THE FACTS AND MATTERS CONTAINED IN THIS FORM ARE TRUE

Signature (of the person making the statement of truth):

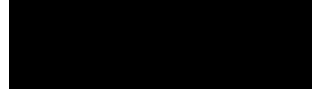

Print full name: NORMAN, ALAN FORSTER.

Date: 1st MARCH, 2015.

You should keep a copy of the completed form

Data protection Act 1998 – Fair Processing Notice

The purpose of this Fair Processing Notice is to inform you of the use that will be made of your personal data, as required by the Data Protection Act 1998.

The appropriate authority in England (i.e. Shropshire Council in the case of this application) is the data controller in respect of any personal data that you provide when you complete this form.

The information that you provide will be used by the appropriate authority in its duties to process application to deposit statements, maps and declarations under section 31(6) the Highways Act 1980 and statements under section 15A(1) of the Commons Act 2006. The information you provide will also be used by the appropriate authority in its duty to update the registers in which details of such deposits are recorded under the Dedicated Highways (Registration of Town or Village Greens) and Dedicated Highways (Landowner Statements and Declarations) (England) Regulations 2013

The appropriate authority is required by the legislation above to maintain a register which holds information provided in this form, which can be inspected online or in person by members of public on request. It may also be required to release information, including personal data and commercial information, on request under the Environmental Information Regulations 2004 or the Freedom of Information Act 2000. However, the appropriate authority will not permit any unwarranted breach of confidentiality nor will they act in contravention of their obligations under the Data Protection Act 1998.

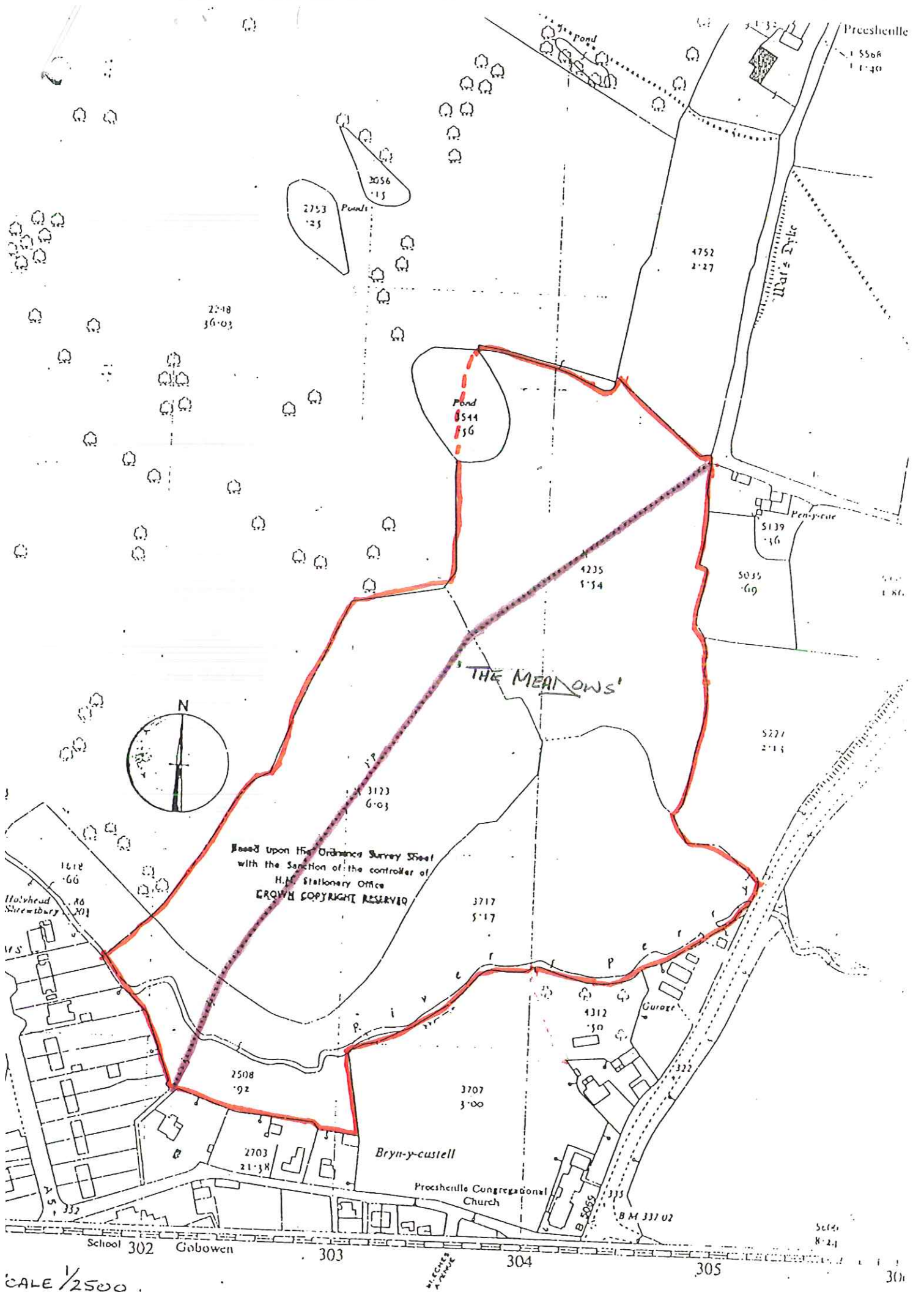

Based upon the Ordnance Survey Sheet
with the sanction of the controller of
H.M. Stationery Office
CROWN COPYRIGHT RESERVED

SCALE 1/2500

