

NOTICE OF PART CONFIRMATION OF MODIFICATION ORDER
WILDLIFE AND COUNTRYSIDE ACT 1981
DEFINITIVE MAP AND STATEMENT OF RIGHTS OF WAY FOR SHROPSHIRE
THE SHROPSHIRE COUNCIL
(TOWN OF SHREWSBURY) MODIFICATION ORDER 2011

On 6th February 2014 the Shropshire Council (“the Council”) confirmed that part of the above named Order to which no objections had been received.

The effect of the Order as confirmed in part is to modify the Definitive Map and Statement for the area by:-

- i) Bridleway Addition, Old Severn Valley Railway – Order Map 3
Adding a Bridleway from point A (SJ 5015 1130) on Order Map 3 where it leaves Pritchard Way, at metal safety barriers running in a general south easterly direction following the embankment of the disused Severn Valley Railway line with a total width of 9 metres with a central surfaced strip of 4 metres to a bridge at point B (SJ 5022 1124) on the Order Map; a total distance of approximately 95 metres.

- ii) Footpath Addition, Nealor’s Lane – Order Map 4
Adding a Footpath from point A (SJ 4833 1303) on Order Map 4 where it leaves an unclassified County Road off The Mount, running between walls with a width of 3 metres along a surfaced route known as Nealor’s Lane running in a general southerly then south south westerly direction providing access to Sprite Cottage. The surfaced path continues between posts which mark the point where it narrows to 2.5 metres, enclosed between fences, turning generally southerly just before reaching point B (SJ 4820 1282) on the Order Map at its junction with Copthorne Road; a distance of approximately 248 metres. Also, a Footpath to be added from point C (SJ 4826 1291) on the Order Map where a spur runs off Nealor’s Lane in a general north westerly direction along a surfaced path enclosed between fences with a width of 1.7 metres to point D (SJ 4824 1292) on the Order Map at the terminus of Granville Street, a cul de sac County Road; a distance of approximately 22 metres.

- iii) Footpath Addition, School Lane – Order Map 5
Adding a Footpath from point A (SJ 4959 1208) on Order Map 5 where it leaves Longden Coleham between low concrete bollards, running in a general southerly direction between walls along a surfaced path known as School Lane, then continuing as a surfaced strip through a grassed area alongside properties to pass between low bollards to exit onto the County Road at point B (SJ 4962 1201) on the Order Map; a distance of approximately 78 metres and a width of 2.2 metres throughout. The surfaced path known as School Lane continues from the opposite side of the County Road at point C (SJ 4962 1201) on the Order Map passing between bollards and running in a general east south easterly direction for a short distance then southerly direction between fences with a width of 2.8 metres then turning to run in a general south easterly direction adjacent to Holy Trinity Church and narrowing to 1.7 metres to exit onto Belle Vue Road between concrete bollards at point D (SJ 4966 1192) on the Order Map; a distance of approximately 112 metres. Also, a Footpath to be added from point E (SJ 4960 1205) on the Order Map where a spur runs off School lane in a general east north easterly direction along a surfaced track, 2.2 metres wide, known as Pound Lane to exit onto Pound Close at point F (4963 1207) on the Order Map; a distance of approximately 33 metres.

- iv) Footpath Addition, Eglan Lane – Order Map 6
Adding a Footpath from point A (SJ 4966 1211) on Order Map 6 where it leaves Longden Coleham and runs past a metal safety barrier in a general south easterly direction as a surfaced path known as Eglan Lane, 1.5 metres wide, enclosed by walls on both sides and adjacent to properties. The path then follows the perimeter of the car park of a public house then narrows to a width of 1 metre where it joins Belle Vue Road at point B (SJ 4974 1203) on the Order Map; a total distance of approximately 108 metres.
- v) Footpath Addition, Londgen Road to Drawwell Street – Order Map 7
Adding a Footpath from point A (SJ 4979 1141) on Order Map 7 where it leaves Longden Road at a metal safety barrier, running in a general south easterly direction as a surfaced path past Sabrina House and is then enclosed between fences and a stone wall where it turns in a general east south easterly direction along the northern perimeter of Roman Road Cemetery. After passing the cemetery the path is enclosed between fences and runs to a metal safety barrier where it exits onto Drawwell Street at point B (SJ 4914 1124) on the Order Map; a total distance of approximately 415 metres with a width of 2.5 metres throughout.
- vi) Footpath Addition, The Pig Trough – Order Map 8
Adding a Footpath from point A (SJ 4910 1343) on Order Map 8 where it leaves Berwick Road at a metal safety barrier, running in a general south south easterly direction along a surfaced path known as the Pig Trough between high brick walls, descending 9 steps with handrails, then continuing between walls and turning to run in a general south easterly direction and then easterly direction shortly before exiting onto Coton Hill via a metal safety barrier at point B (SJ 4919 1334) on the Order Map; a total distance of approximately 132 metres with a width of 1.5 metres throughout.
- vii) Footpath Addition, The Flash – Order Map 9
Adding a Footpath from point A (SJ 4870 1353) on Order Map 9 where it leaves Gravel Hill Lane and runs across a surfaced area in a general southerly then general east south easterly direction for a short distance and then continues along a surfaced path known as The Flash bounded by a wall and woodland on the southern boundary then becoming enclosed by walls and fencing between gardens, then opening out into a lawned area where it follows the riverside edge of the garden in a general easterly direction to ascend six steps in a northerly direction to its junction with The Pig Trough at point B (SJ 4913 1337) on the Order Map; a total distance of approximately 470 metres with a width of 3 metres throughout.

A copy of the Order and the Order maps may be seen free of charge at the Council offices at The Shirehall, Abbey Foregate, Shrewsbury during normal office hours. Copies of the Order and maps may also be bought from the Council at the above address at a price of £6.50.

The Order becomes operative as from 6th February 2014, but if a person aggrieved by the Order desires to question the validity thereof, or of any provision contained therein, on the grounds that it is not within the powers of Section 53 or 54 or that any of the requirements of Schedule 15 have not been complied with in relation to the Order he may, under paragraph 12 of Schedule 15, within 42 days from the date of publication of the notice make an application to the High Court.

Dated 6th February 2014
DEB HUGHES
SERVICE MANAGER OUTDOOR RECREATION
ECONOMIC GROWTH AND PROSPERITY

The Shirehall, Abbey Foregate, Shrewsbury.

If you require any further information please contact Jean Jones on 01743 255056



Key

Route to be added
Existing to remain

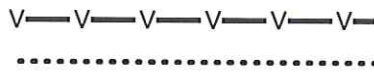

Scale: 1:2,000

The Shirehall, Abbey Foregate
 Shrewsbury, Shropshire, SY2 6ND

© Crown copyright and database rights 2011
 Ordnance Survey 100049049
 You are not permitted to copy, sub-licence,
 distribute or sell any of this data
 to third parties in any form.





The Shirehall, Abbey Foregate
 Shrewsbury, Shropshire, SY2 6ND

Key

Route to be added
Existing to remain



Scale: 1:1,500

© Crown copyright and database rights 2011
 Ordnance Survey 100049049
 You are not permitted to copy, sub-licence,
 distribute or sell any of this data
 to third parties in any form.

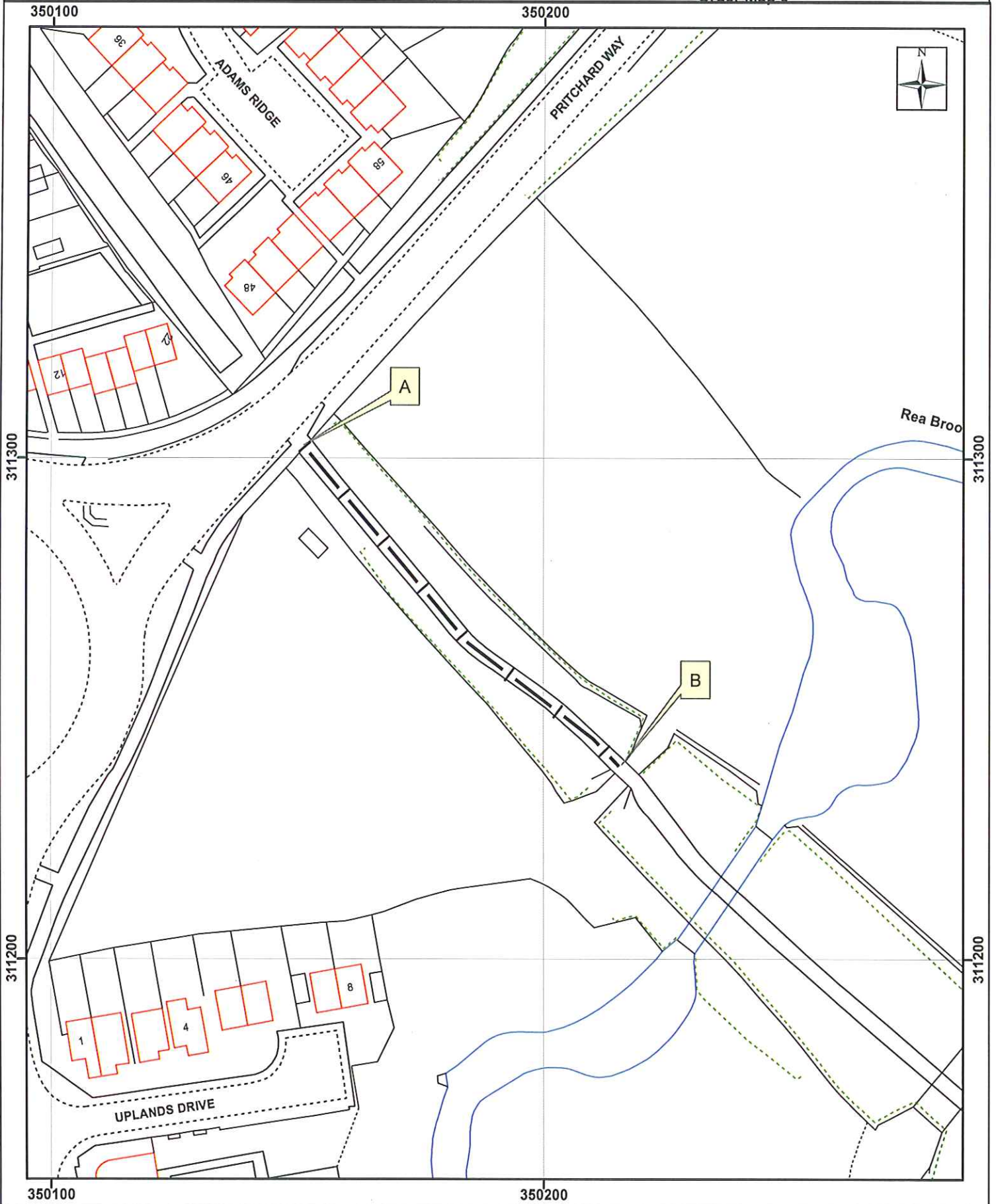

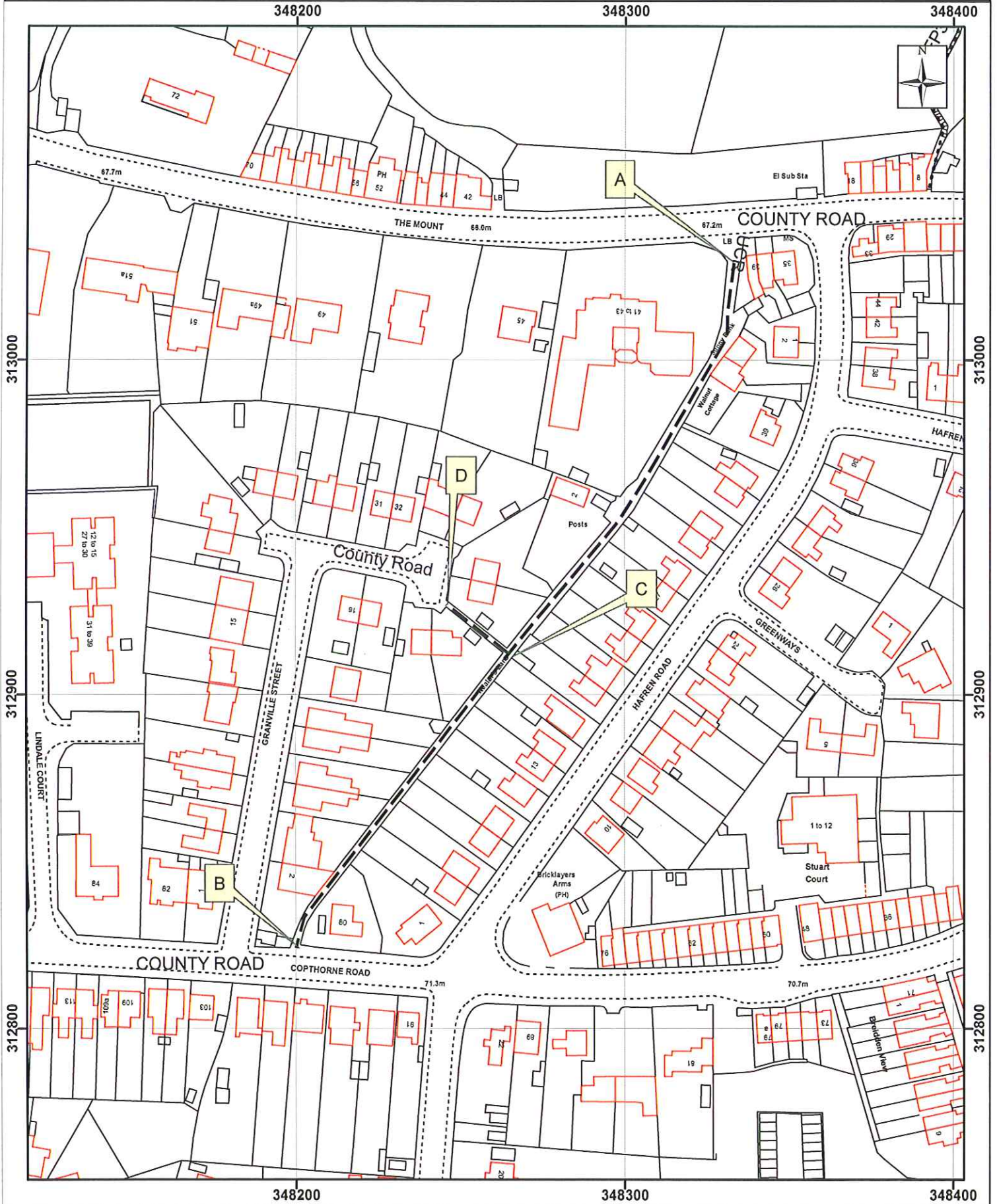



The Shirehall, Abbey Foregate
 Shrewsbury, Shropshire, SY2 6ND

Key
 Route to be added ————

Scale: 1:1,000

© Crown copyright and database rights 2011
 Ordnance Survey 100049049
 You are not permitted to copy, sub-licence,
 distribute or sell any of this data
 to third parties in any form.

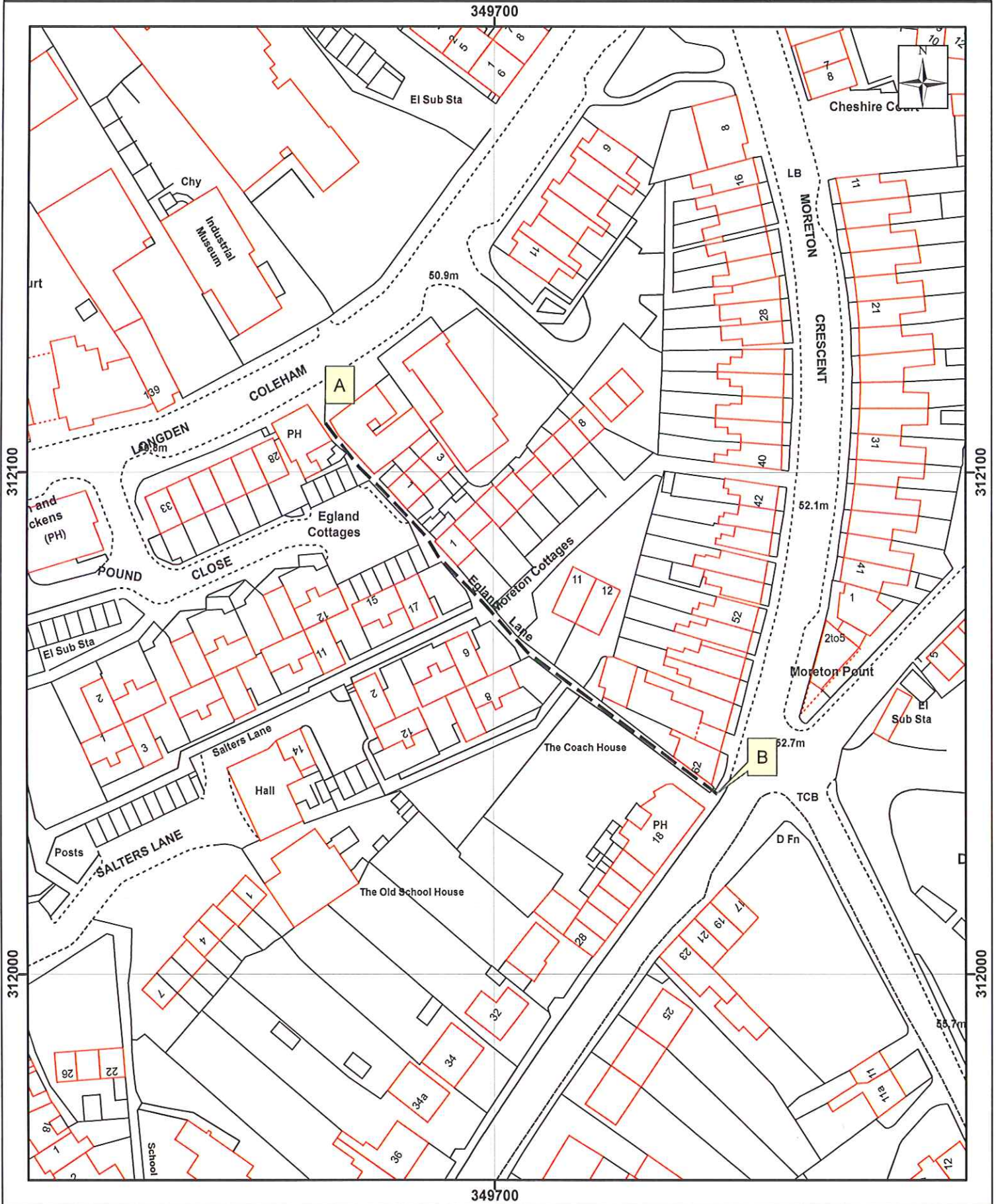

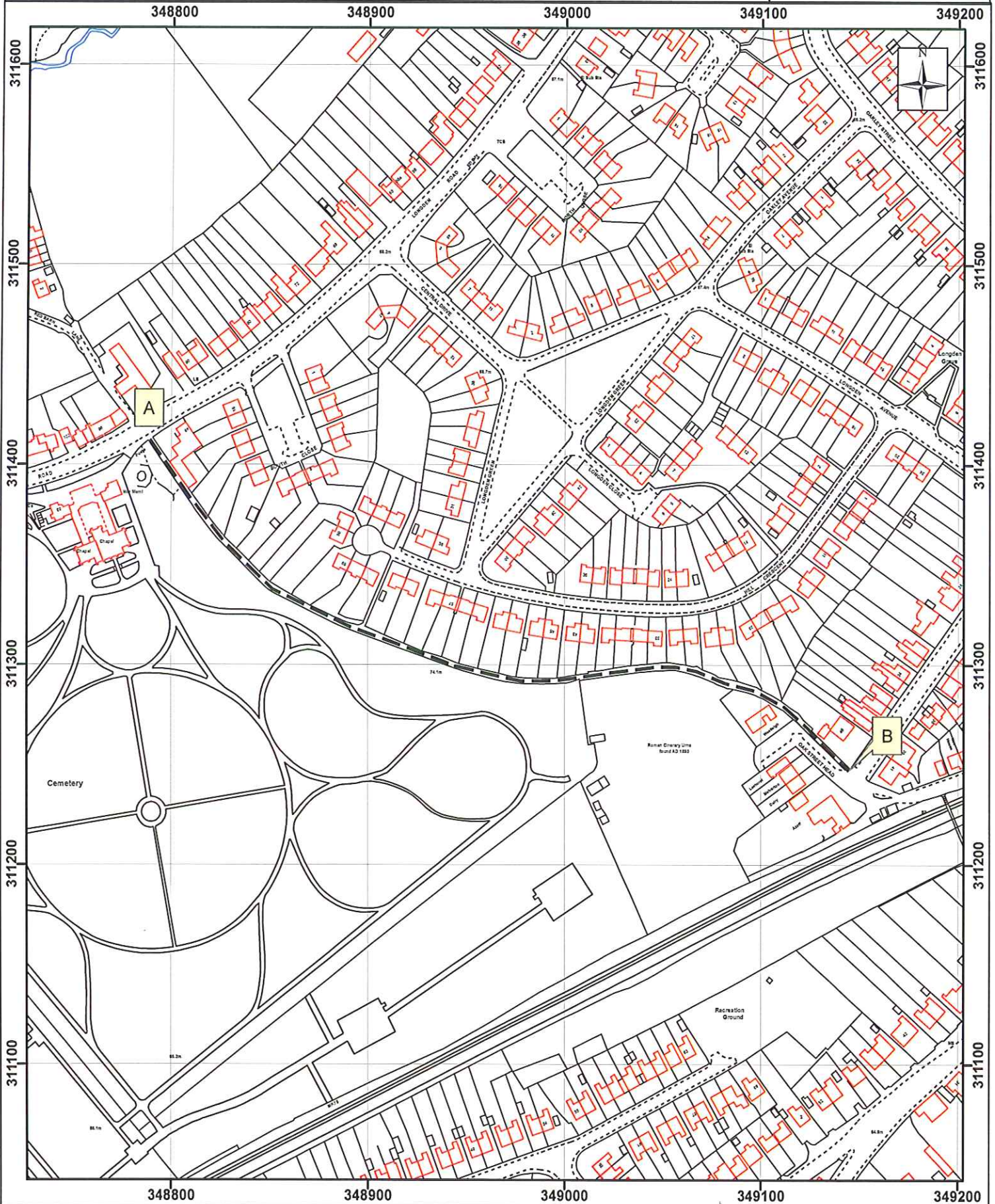

The Shirehall, Abbey Foregate
Shrewsbury, Shropshire, SY2 6ND

Key

Route to be added - - - - -

Scale: 1:2,500

© Crown copyright and database rights 2011
Ordnance Survey 100049049
You are not permitted to copy, sub-licence,
distribute or sell any of this data
to third parties in any form.

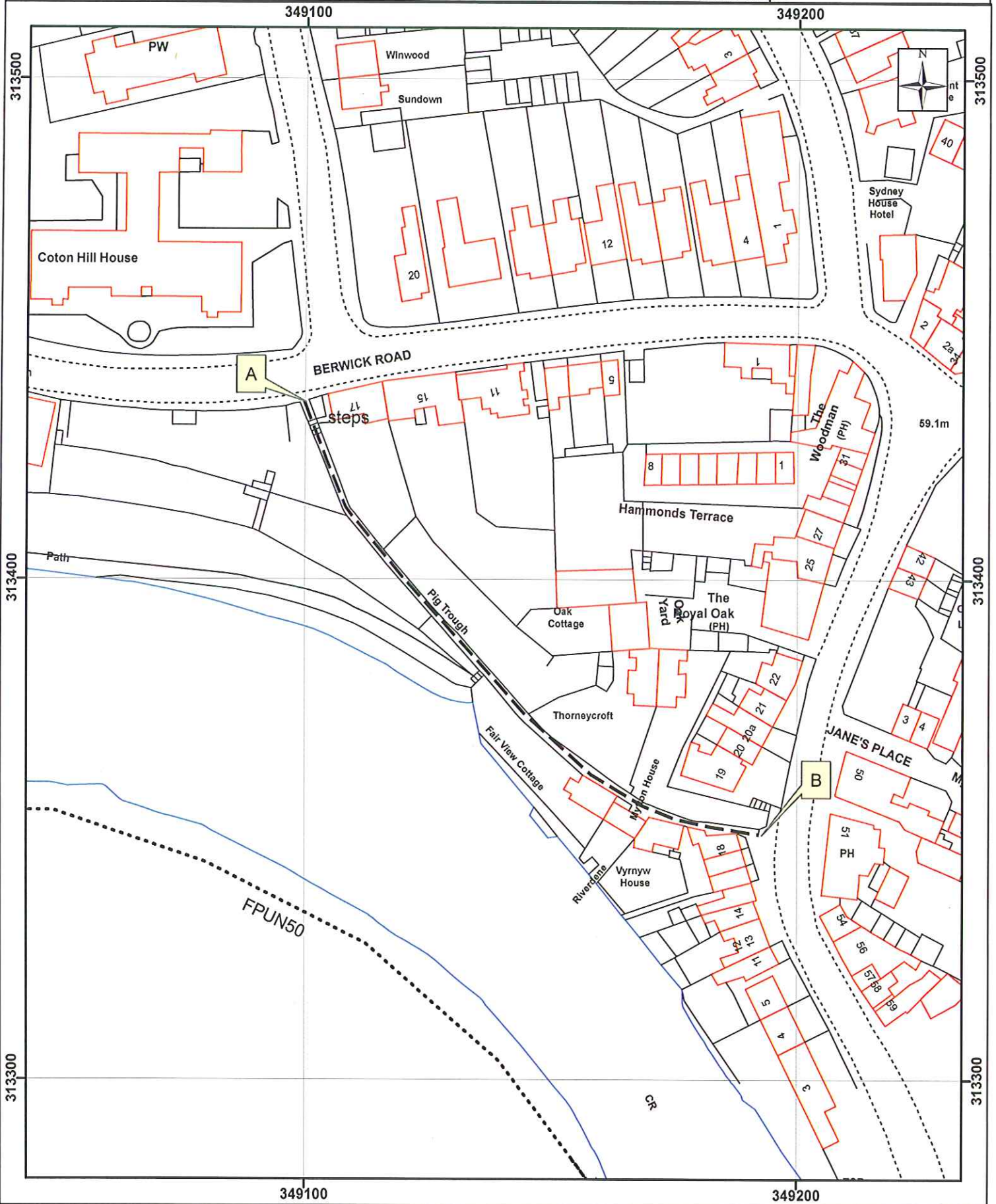

SHROPSHIRE COUNCIL
WILDLIFE AND COUNTRYSIDE ACT 1981
Definitive Map Modification Order 2011

Town of Shrewsbury
Footpath Addition
OS Sheet No: SO 48 13
Order Map 9

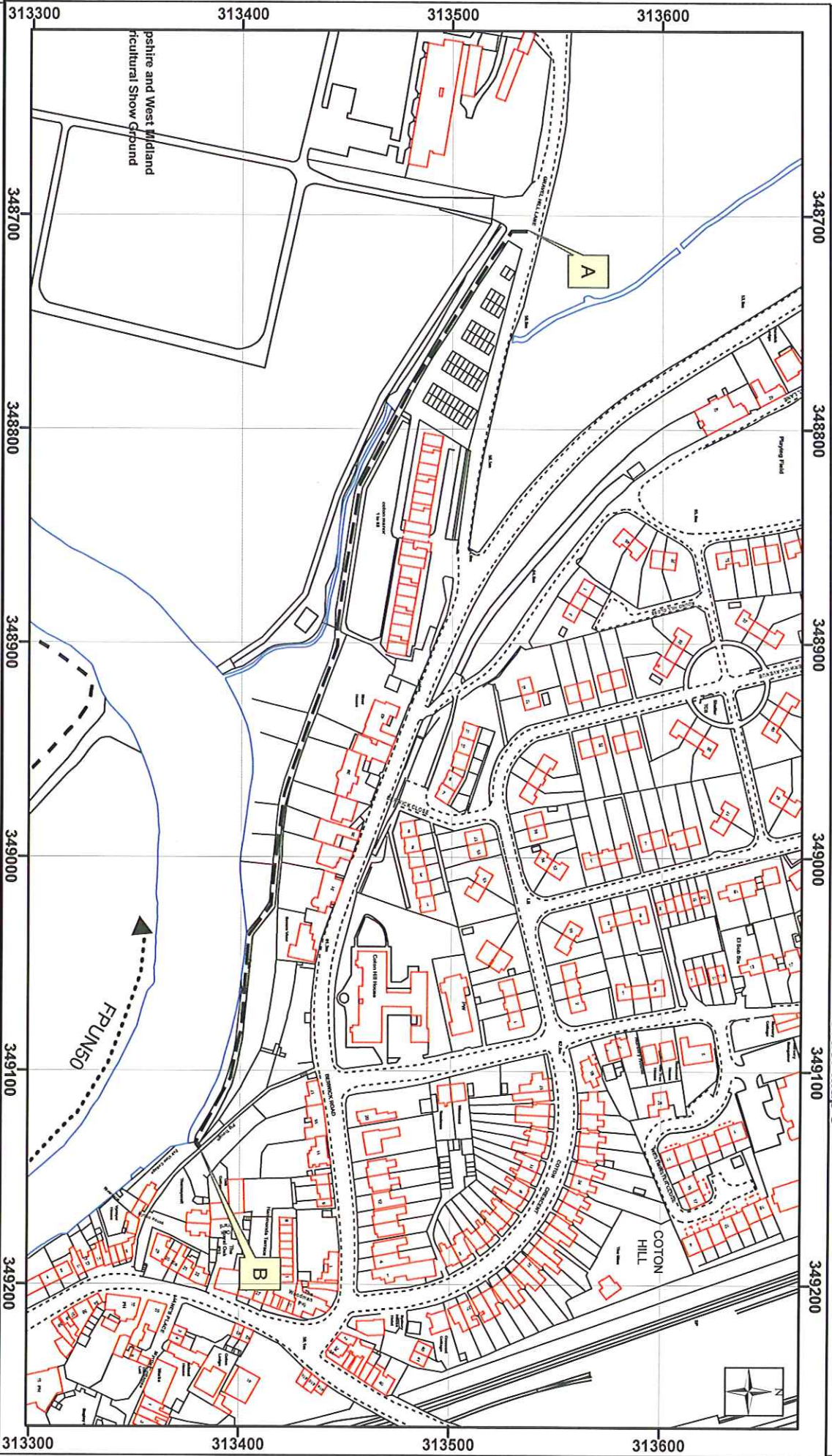

Key

Route to be added
 Existing to remain

Scale: 1:2,590

© Crown copyright and database rights 2011
 Ordnance Survey 100049049
 You are not permitted to copy, sub-licence,
 distribute or sell any of this data
 to third parties in any form.



The Shirehall, Abbey Foregate
 Shrewsbury, Shropshire, SY2 6ND