

Kerb type HB2 shown  
on SD-1100-01.

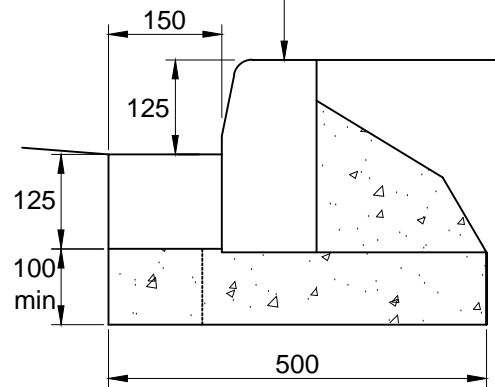

Channel Type CS2-150x125

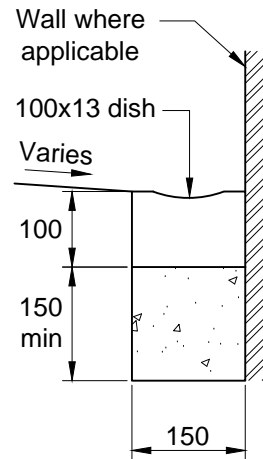

Channel Type CD2-150x125 dished  
(No longer a BSEN 1340 Product)

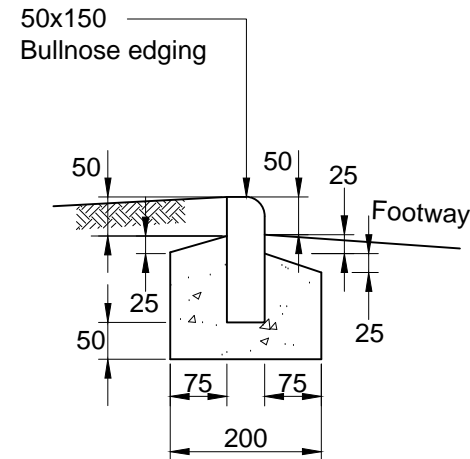

Edging Type EBN-Raised

#### Notes:

1. Refer also to Appendix 11/1 of the specification.
2. All dimensions are in millimetres unless otherwise stated.
3. Concrete type to be ST1 in accordance with BS 8500-02.

Kerb type as  
shown elsewhere.

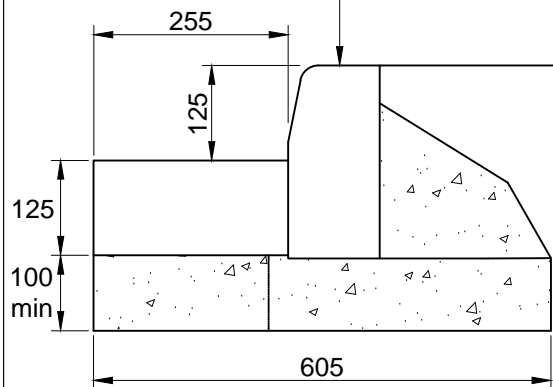

Channel Type CS1-255x125

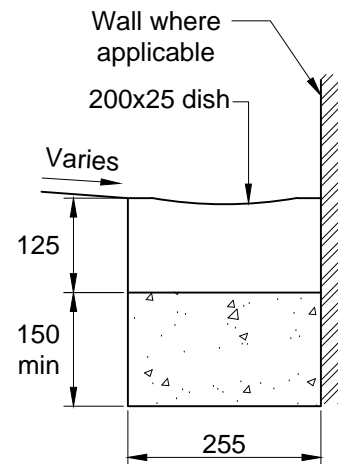

Channel Type CD-255x125 dished  
(Use where there are no DDA issues)

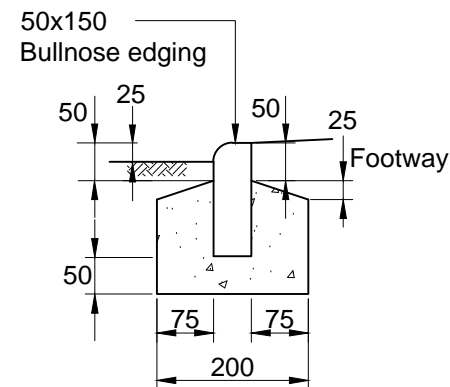

Edging Type EBN-Flush

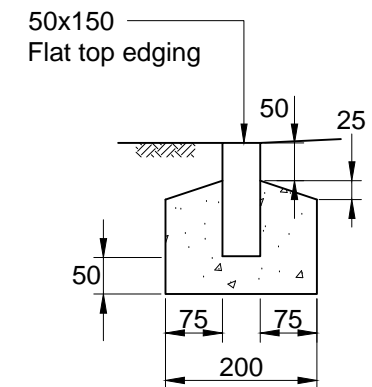

Edging Type EF



## Standard Detail Channel and Edging Details

Version	Amendment	Date
Checked By: M. Batham	Drawing Number: SD-1100-02	Version: -
Date Issued: Oct 16		